

# MAKKA POHA\_PRODUCTION LINE & EQUIPMENTS

**CAPACITY- 500 - 1000 - 2000 - 3000 KGHR**

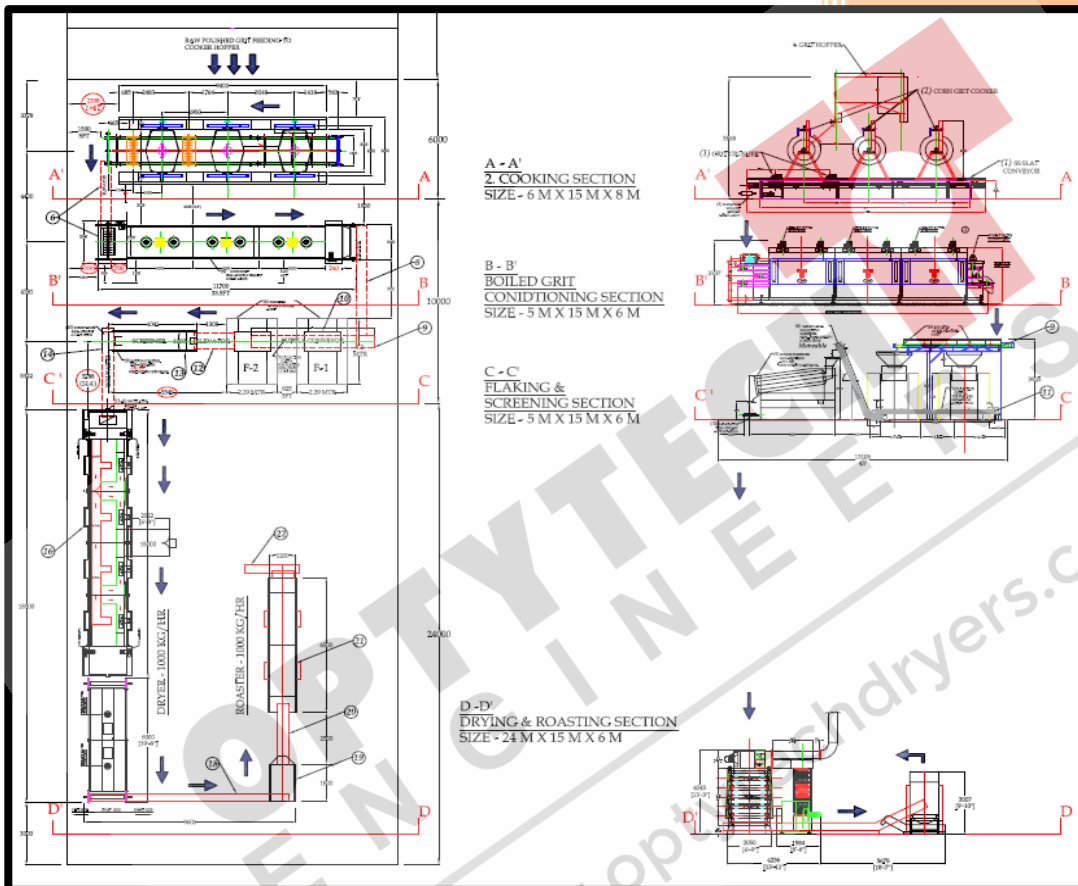

**MAKKA POHA**

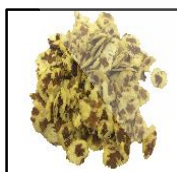

**CHANA FLAKES**



**MUNG FLAKES**



**RICE FLAKES**



**JUVAR FLAKES**



**BAJRA FLAKES**



**WHEAT FLAKES**



**RAGI FLAKES**

## OPTYTECH ENGINEERS

4356 – PAHSE- 3 ROAD NO – E END DARED  
JAMNAGER – GUJARAT - 361005 – INDIA

sales@optytechdryers.com

optimy@rediffmail.com

+91- 9227733535 / +91- 7567869495

## A – MAKKA CLEANING SECTION

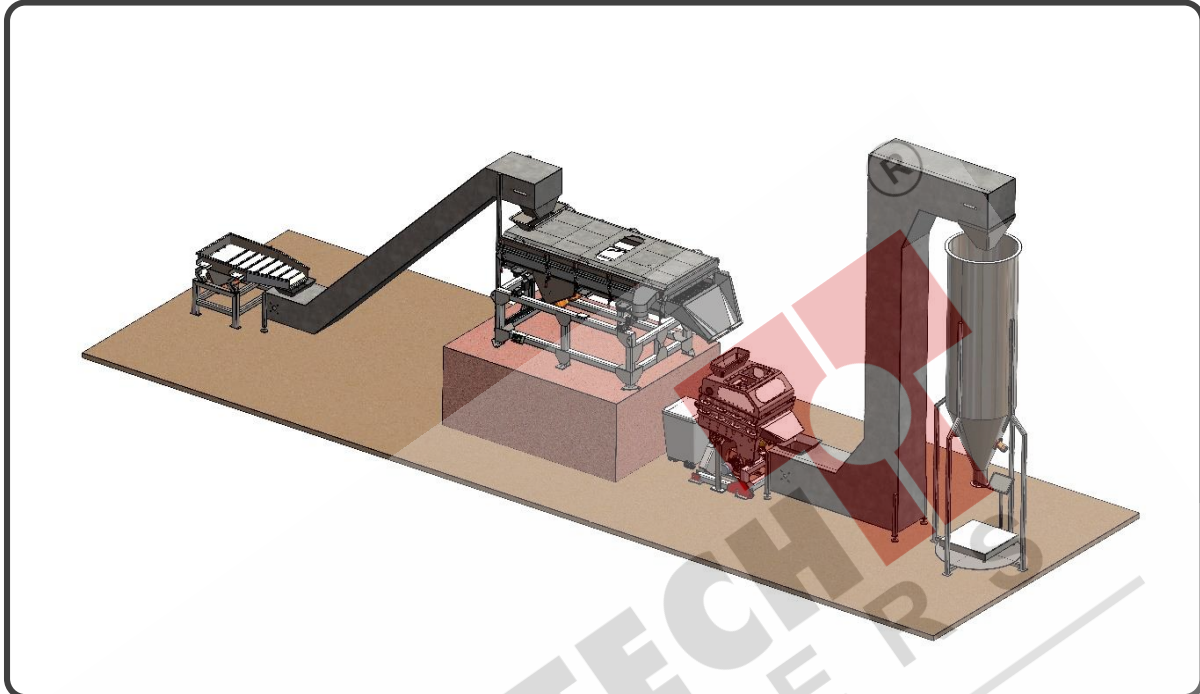

(DESIGN RIGHTS RESERVED BY OPTYTECH ENGINEERS)

### APPLICATION

Makka (corn) grains required cleaning before the polishing process. The impurities such as stones, leaves, other foreign particles will be removed in this section from the corn grains before further processing.

### LIST OF MACHINE & EQUIPMENTS

SR	NAME	CAPACITY	KW	SIZE (L X W X H)
1	BULK HOPPER WITH FEEDING ELEVATOR			
2	MAGNETIC DESTONER MC			
3	SCREW ELEVATOR TO PRESSURE DESTONER			
4	PRESSURE DESTONER MC			
5	AIR CLASSIFIER			
6	GRADING / SCREENING MC			
7	SCREW ELEVATOR TO POLISHING SECTION			
8	ELECTRIC CONTROL PANEL SEC-A			

**CAPACITY & OTHER DETAILS SHOULD BE PROVIDED ON DEMAND**

## B – MAKKA POLISHING SECTION

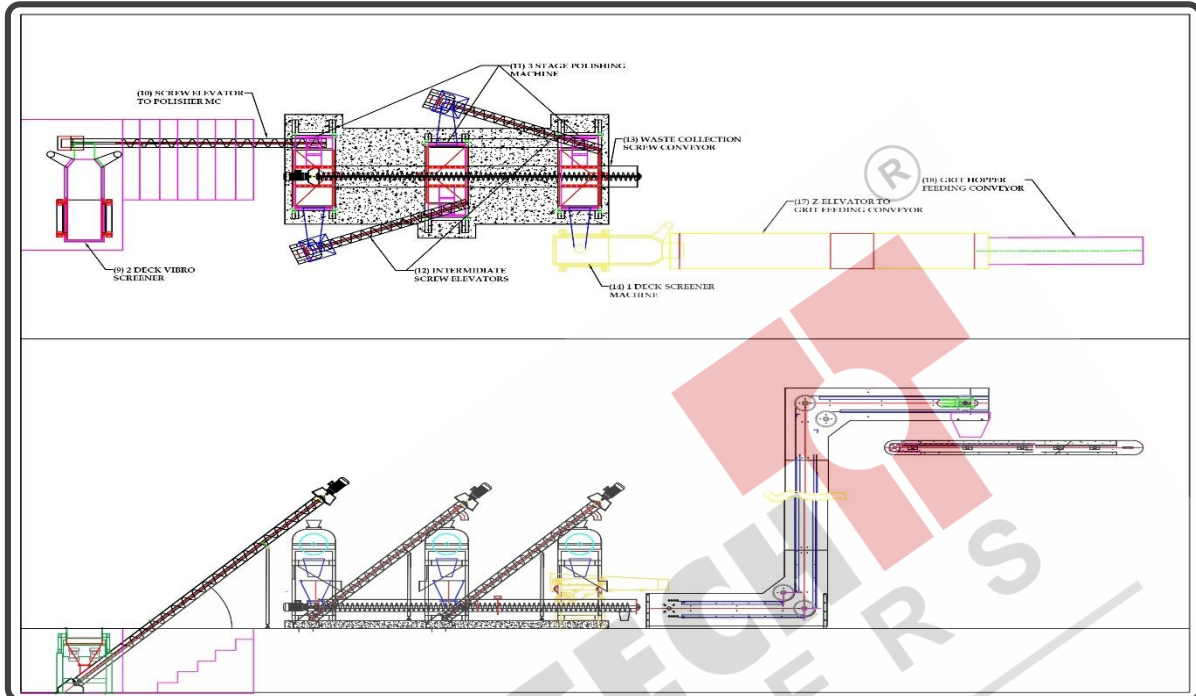

(DESIGN RIGHTS RESERVED BY OPTYTECH ENGINEERS)

### APPLICATION

The Germ and upper layer of the corn grains will be removed in this process and separated from the grits. The grits will go for further process.

### LIST OF MACHINE & EQUIPMENTS

SR	NAME	CAPACITY	KW	SIZE (L X W X H)
9	2 DECK VIBRO SCREENER			
10	SCREW ELEVATOR TO POLISHER MC			
11	3 STAGE POLISHING MC			
12	INTERMEDIATE SCREW ELEVATOR			
13	WASTE COLLECTION SCREW CONVEYOR			
14	1 DECK SCREENER MC			
15	SCREW ELEVATOR CLEANING & BRUSHING			
16	CLEANING & BRUSHING MC			
17	Z ELEVATOR TO GRIT HOPPER FEEDING CONVEYOR			
18	GRIT HOPPER FEEDING CONVEYOR			
19	BEEN BOX DRYER			
20	ELECTRIC CONTROL PANEL SEC-B			

**CAPACITY & OTHER DETAILS SHOULD BE PROVIDED ON DEMAND**

## C – BOILING SECTION

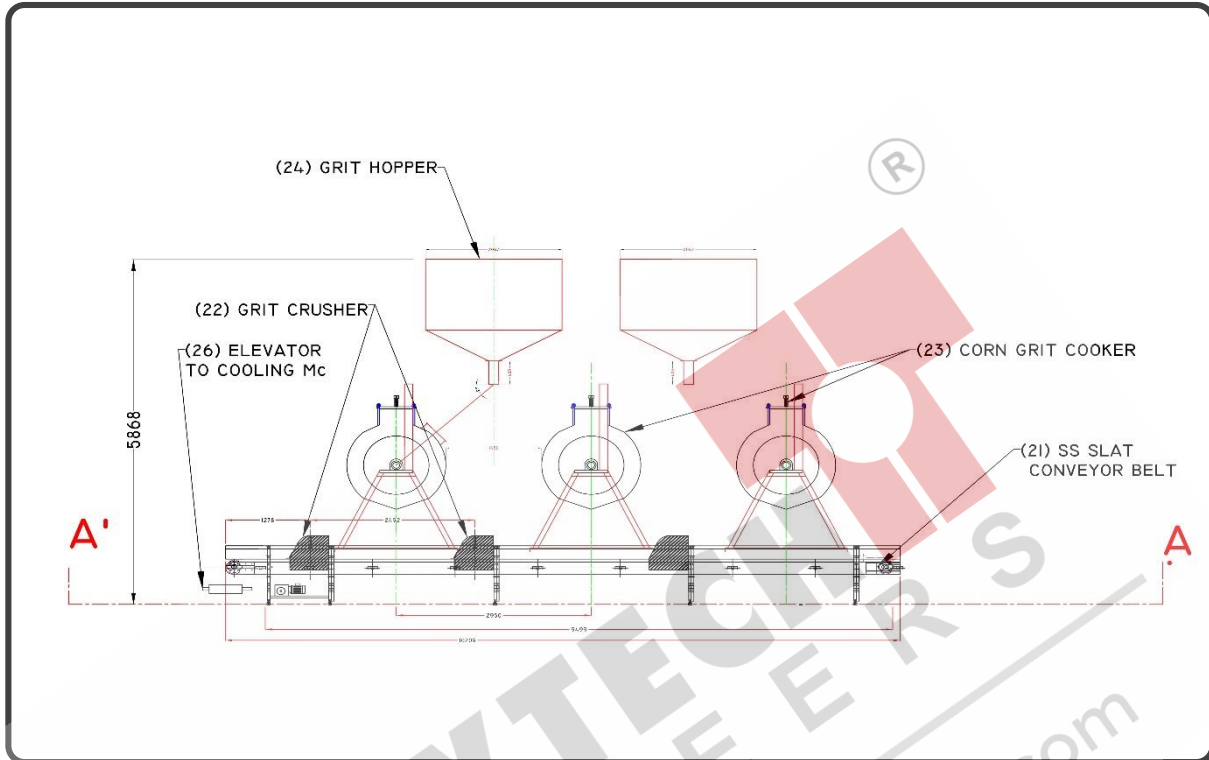

(DESIGN RIGHTS RESERVED BY OPTYTECH ENGINEERS)

## APPLICATION

Corn grits supplied in the cooker batch wise. These cookers cooked the corn grits. Cooked grits is needful in for the flakes generation.

## LIST OF MACHINE & EQUIPMENTS

SR	NAME	CAPACITY	KW	SIZE (L X W X H)
21	SS SLAT BELT CONVEYOR BELT FOR COOKER			
22	BOILED GREET CRUSHER- SS304			
23	CORN GREET COOKER			
24	STORAGE HOPPER WITH DUAL OUTLET & STRUCTURE			
25	AUTO CONTROL SYSTEM & PANEL FOR COOKER			
26	SS COATED CLEATED BELT FOR SUPPLY TO COOLING MC			

**CAPACITY & OTHER DETAILS SHOULD BE PROVIDED ON DEMAND**

## D – BOILED MAKKA GRIT CONDITIONING SECTION

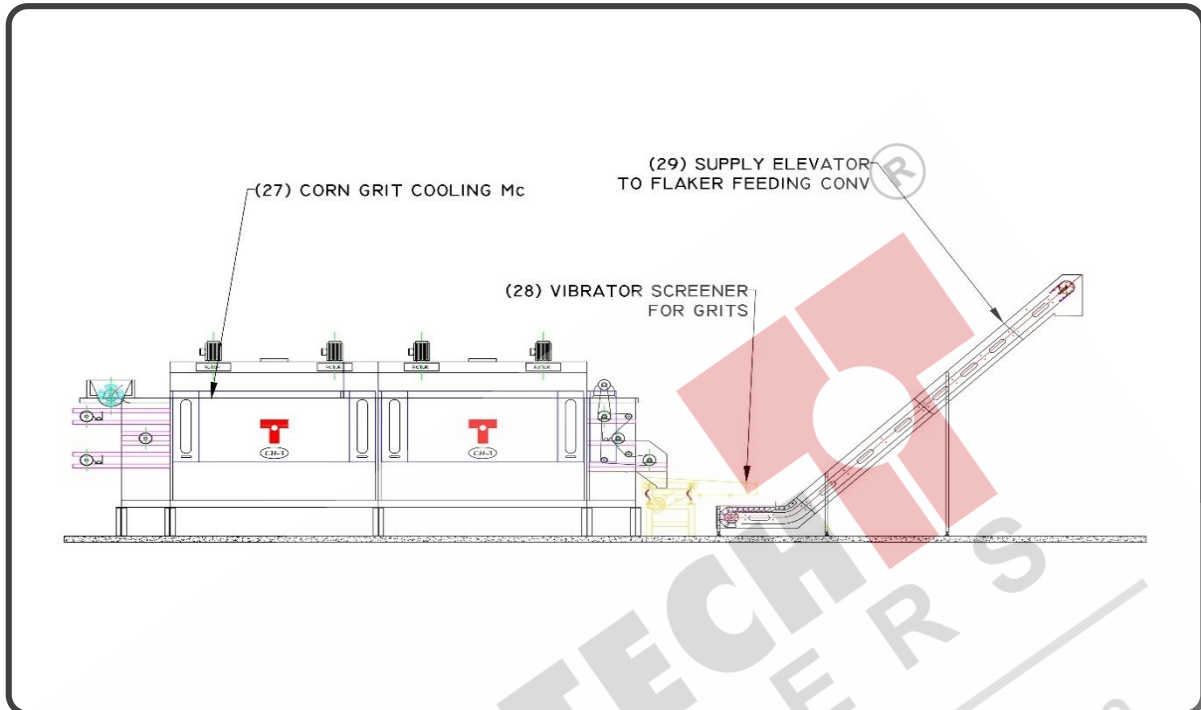

(DESIGN RIGHTS RESERVED BY OPTYTECH ENGINEERS)

### APPLICATION

Boiled / cooked Grits needs to be cooled before the flaking operation for the uniform flakes operation. Boiled grits cooled in the cooling machine and goes to flaking section.

### LIST OF MACHINE & EQUIPMENTS

SR	NAME	CAPACITY	KW	SIZE (L X W X H)
27	3 LEAYER CORN GREET COLLING MC			
28	SCREENER FOR GRITS			
29	SUPPLY ELEVATOR CLEATED BELT TO FLEACKER MC			

**CAPACITY & OTHER DETAILS SHOULD BE PROVIDED ON DEMAND**

## E – MAKKA FLAKING SECTION

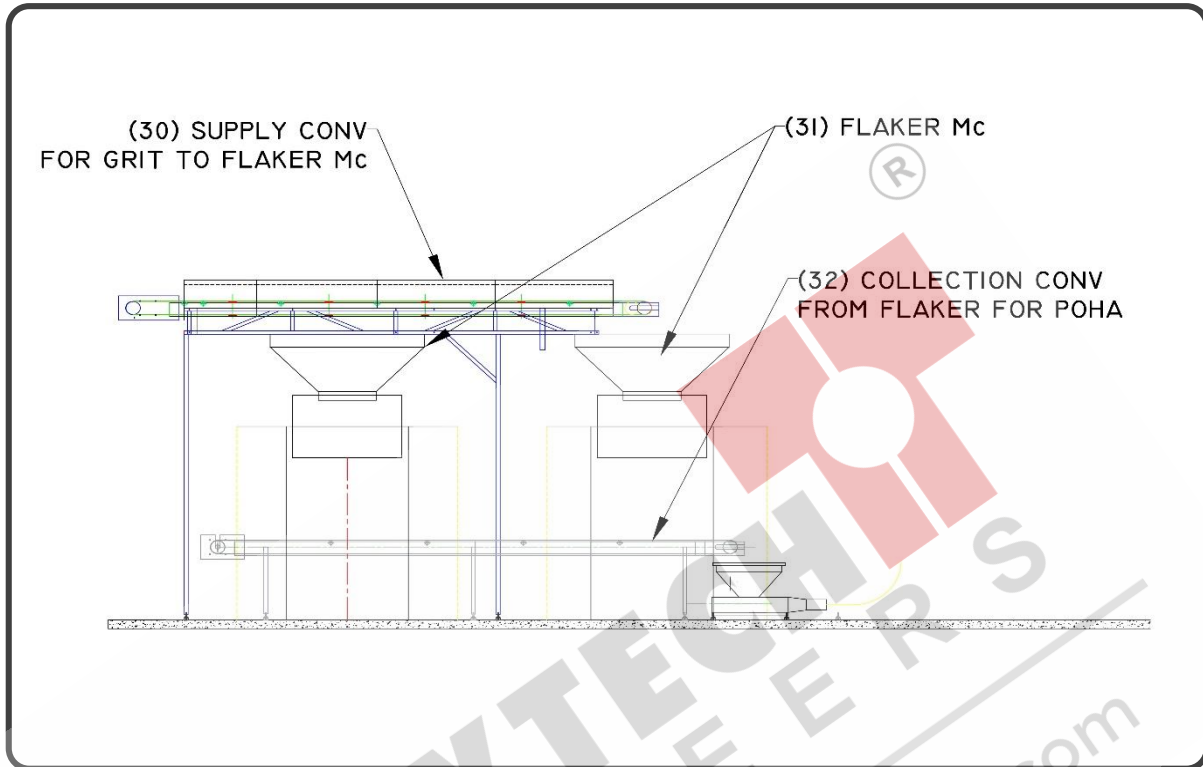

(DESIGN RIGHTS RESERVED BY OPTYTECH ENGINEERS)

### APPLICATION

Boiled corn grits pressed between the two rollers to form the flakes in the flaker machine. These flakes collected by collection conveyor belts and supplied to the screening & drying section.

### LIST OF MACHINE & EQUIPMENTS

SR	NAME	CAPACITY	KW	SIZE (L X W X H)
30	SUPPLY CONVEYOR FOR GREET TO FLACKER MC			
31	FLACKER MC			
32	COLLECTION CONVEYOR FOR POHA FROM DLACKER			
33	ELECTRIC CONTROL PANEL SEC- C			

CAPACITY & OTHER DETAILS SHOULD BE PROVIDED ON DEMAND



## F – MAKKA FLACK SCREENING & DRYING SECTION

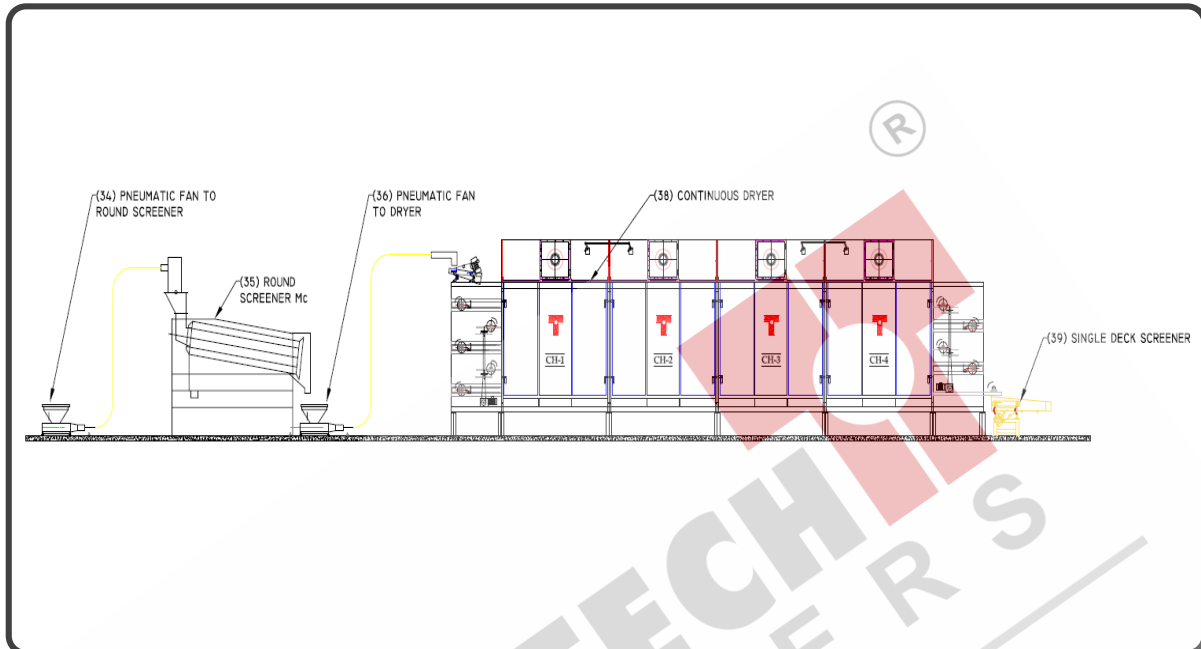

(DESIGN RIGHTS RESERVED BY OPTYTECH ENGINEERS)

### APPLICATION

Corn (Makka) flakes screened in the screener machine. The screener machine will remove the small size flakes & powder. Accepted flakes supplied to dryer machine for the drying. The flakes dried in the dryer machine and again it will be screened before final packing.

### LIST OF MACHINE & EQUIPMENT

SR	NAME	CAPACITY	KW	SIZE (L X W X H)
34	PNEUMATIC FAN FOR POHA TO ROUND SCREENER			
35	ROUND SCREENER WITH WASTE CONVEYOR			
36	SUPPLY ELEVATOR TO DRYER			
37	ELECTRIC CONTROL PANEL SEC- D			
38	CONTINUOUS DRYER			
39	SINGLE DECK SCREENER FOR POHA			

CAPACITY & OTHER DETAILS SHOULD BE PROVIDED ON DEMAND

## G – FINISH PRODUCT COLLECTION & PACKING SECTION

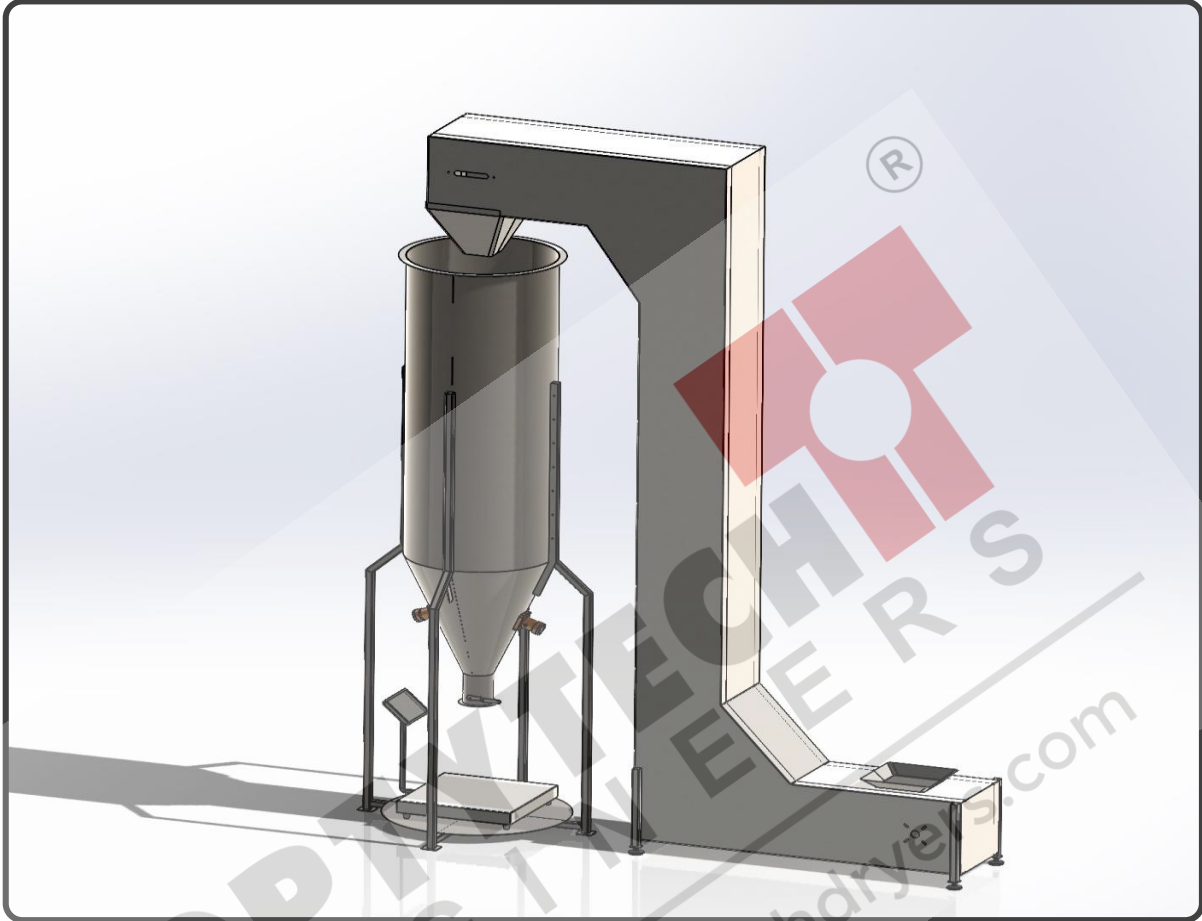

(DESIGN RIGHTS RESERVED BY OPTYTECH ENGINEERS)

### APPLICATION

The Dried flakes collected in the silo and packed.

### FEATURES

- For storage drying product.
- Allow for packing facility.



**SHED LAYOUT FOR MAKKA POHA PRODUCTION LINE CAP - 500 KG/HR**

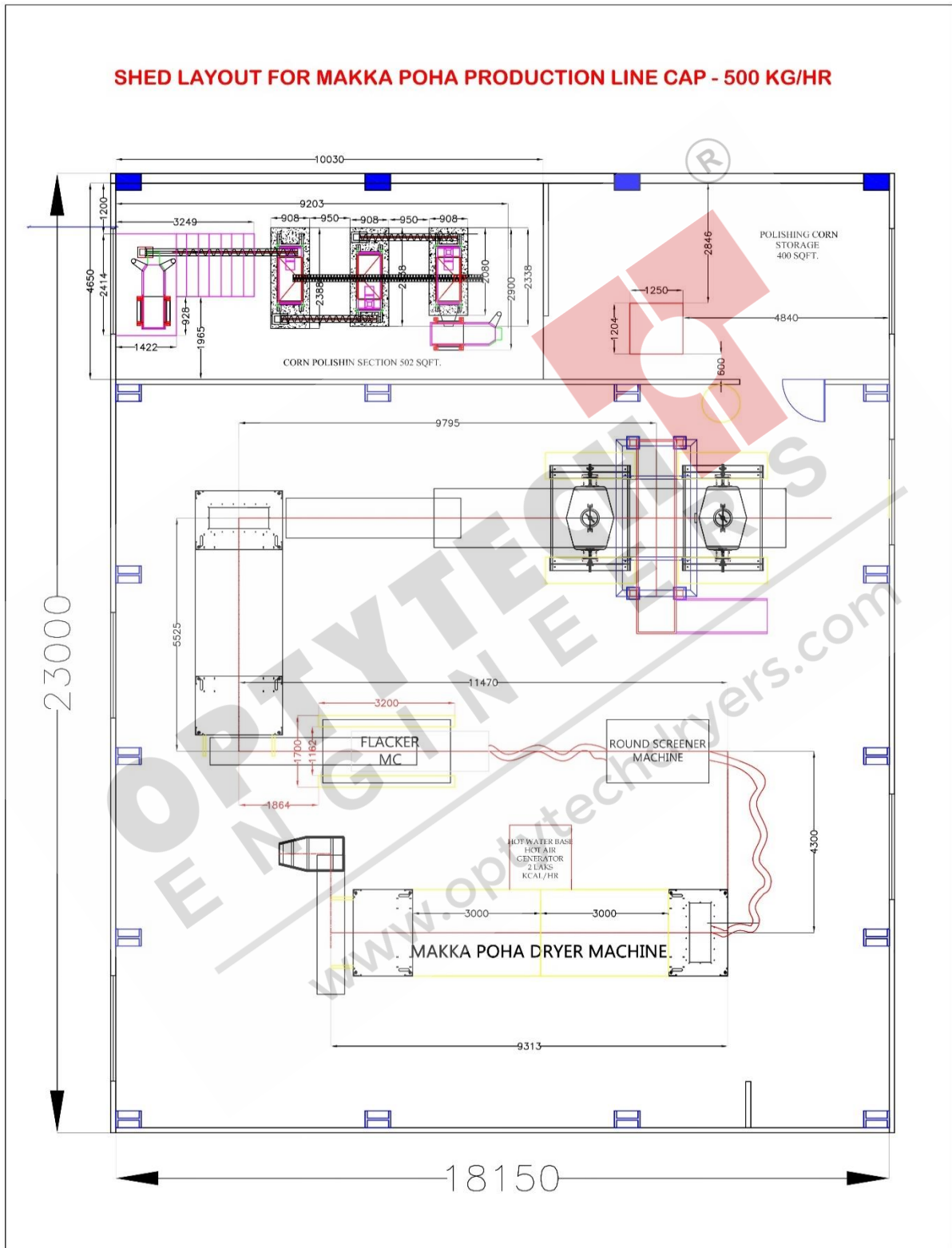

**SHED LAYOUT FOR MAKKA POHA PRODUCTION LINE EQUIP - 1000 KG/HR CAP**

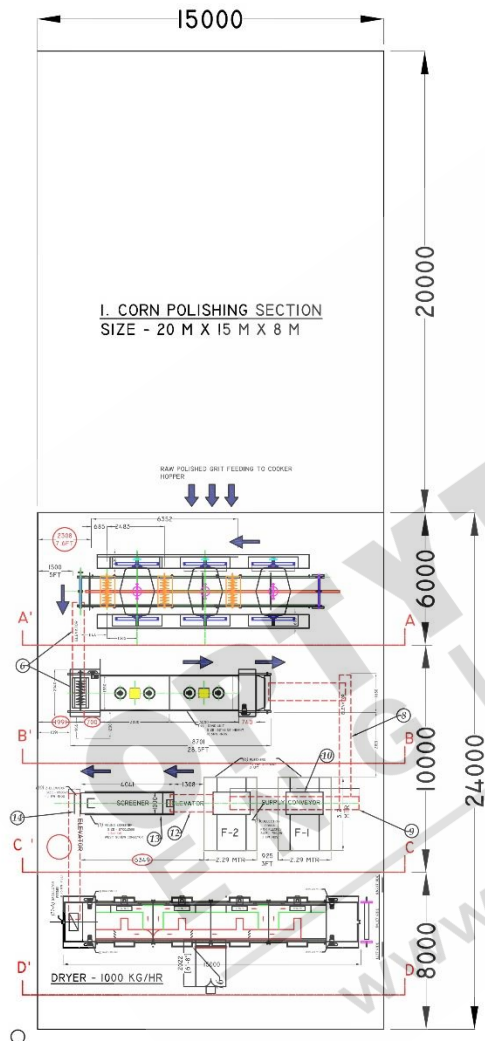

SHED DIMENSIONS SECTION WISE		
	PROCESSING SECTION	SHED SIZE (L X W X H)
1	CORN POLISHING SECTION	20 M X 15 M X 8 M
2	CORN GRIT COOKING SECTION	6 M X 15 M X 8 M
GRIT POLISHING & COOKING TOTAL SHED SIZE		26 M X 15 M X 8 M
3	CONDITIONING SECTION	5 M X 15 M X 6 M
4	FLAKING SECTION	5 M X 15 M X 6 M
5	DRYING SECTION	24 M X 15 M X 6 M
CONDI & DRYING SECTION TOTAL SHED SIZE		34 M X 15 M X 6 M
6	BOILER SECTION - CAP 1200 KG/HR STEAM	DECIDED BY CLIENT
7	RAW MATERIAL STORAGE SEC	DECIDED BY CLIENT
8	FINISHED GOODS STORAGE SECTION	DECIDED BY CLIENT

**SHED DIMENSIONS - IN L X W X H**  
**44 M X 15 M X 26 M = 145' FT X 50' FT X 26' FT**

**A - A'**  
**2. COOKING SECTION**  
SIZE - 6 M X 15 M X 8 M

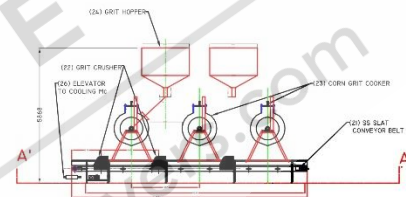

**B - B'**  
**BOILED GRIT**  
**CONDITIONING SECTION**  
SIZE - 5 M X 15 M X 6 M

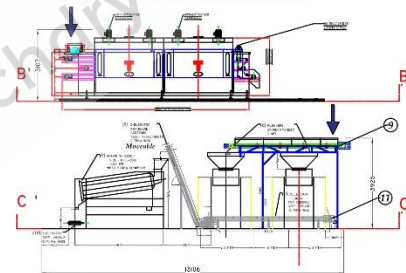

**C - C'**  
**FLAKING &**  
**SCREENING SECTION**  
SIZE - 5 M X 15 M X 6 M

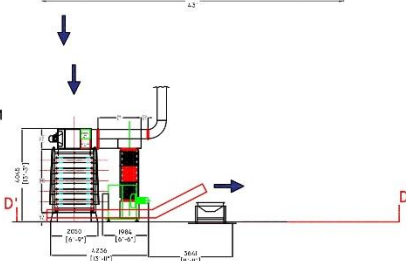

**D - D'**  
**DRYING SECTION**  
SIZE - 24 M X 15 M X 6 M

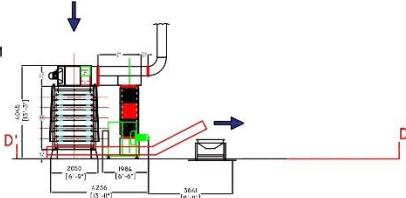

**SHED LAYOUT FOR MAKKA POHA PRODUCTION LINE EQUP - 2000 KG/HR CAP**

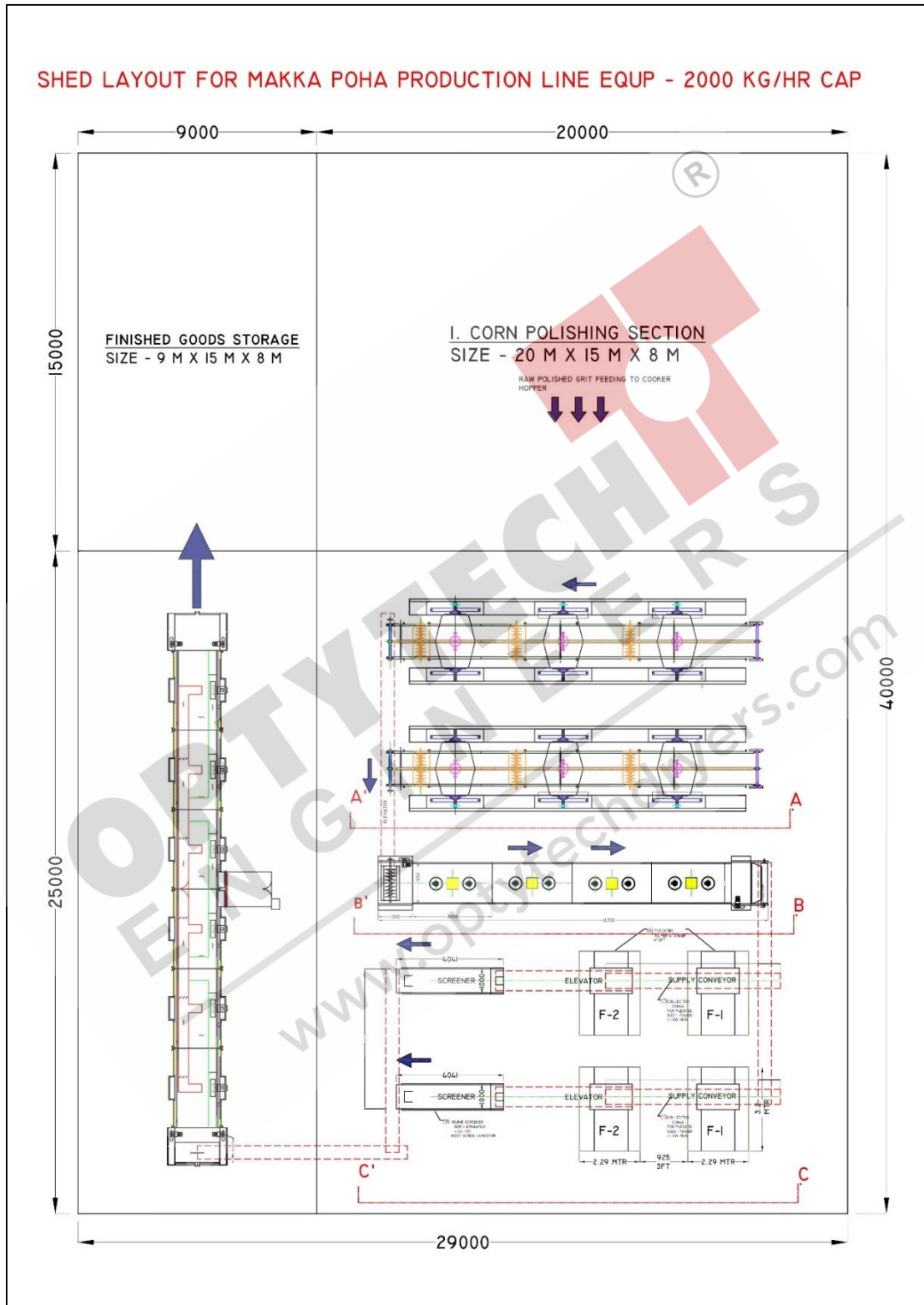

(DESIGN RIGHTS RESERVED BY OPTYTECH ENGINEERS)